

GBSL, GBSLM, GBESL series

Ordering code

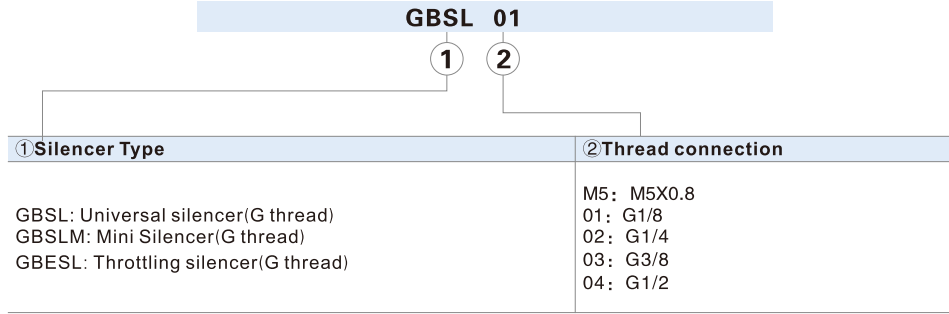

Product feature

1. This silencers have excellent noise silencing performance.
2. The installation of the silencer is simple and convenient, and the connecting portion is reliable and durable.
3. It is easy to adjust the exhaust flow of the throttling type silencer.

Configuration table of tubing thread

Product series	Thread connection				
	M5	01	02	03	04
GBSL	●	●	●	●	●
GBSLM	●	●	●	●	●
GBESL		●	●	●	●

Specification

Model	GBSLM5	GBSL01	GBSL02	GBSL03	GBSL04	GBSLMM5	GBSLM01	GBSLM02	GBSLM03	GBSLM04
Thread connection	M5×0.8	G1/8	G1/4	G3/8	G1/2	M5×0.8	G1/8	G1/4	G3/8	G1/2
Silencing effect(dB)(0.5MPa)	15	20	20	20	12	15	20	20	20	20

Model	GBESL01	GBESL02	GBESL03	GBESL04
Thread connection	G1/8	G1/4	G3/8	G1/2
Silencing effect(dB)(0.5MPa)	20	20	20	20

Operating pressure	0~10kgf/cm ² (0~1.0MPa)
Negative pressure	-750mmHg(10Torr)
Proof pressure	1.5MPa
Temperature range	-20~70℃

Inner structure

GBSL Series

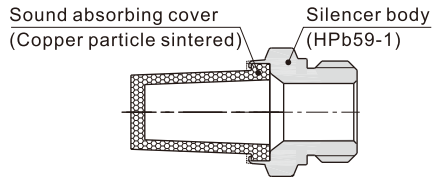

GBESL Series

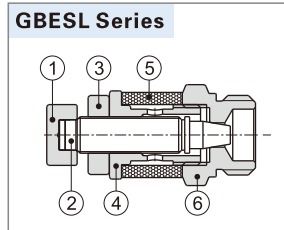

NO.	Name	Material
1	Adjusting cap	Aluminum alloy
2	Throttling column	Aluminum alloy
3	Locking cap	Aluminum alloy
4	Locking ring	Aluminum alloy
5	Silencer ring	Copper particle sintered
6	Silencer body	Brass

Flowrate characteristic

GBSL Series

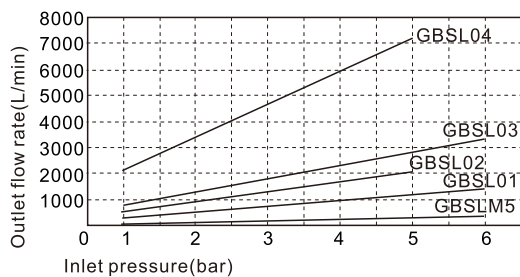

GBSLM Series

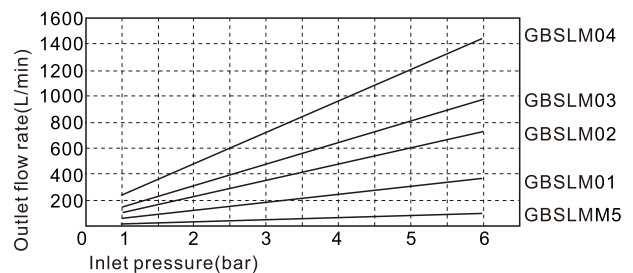

GBSL, GBSLM, GBESL series

Flowrate characteristic

GBESL Series (Inlet pressure and outlet flow rate)

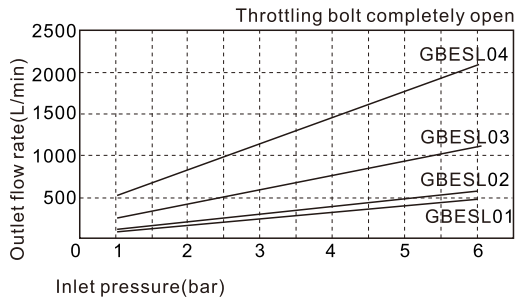

GBESL Series

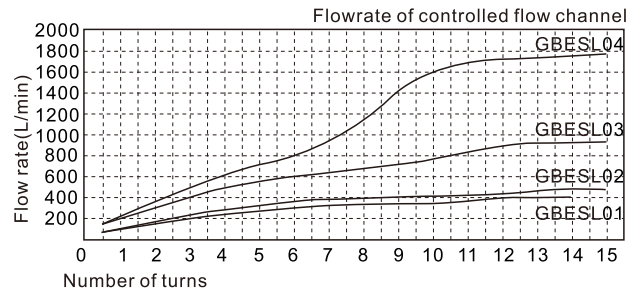

Dimensions

GBSL Series

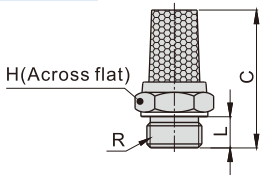

Model/Item	R	L	C	H	Weight(g)	PCS/bag
GBSLM5	M5×0.8	3.5	19.5	8	2.9	10
GBSL01	G1/8	5.5	24	12	6.8	10
GBSL02	G1/4	6.5	29.5	15	11.3	10
GBSL03	G3/8	7	37.5	19	21.1	10
GBSL04	G1/2	8.5	45	22	33.6	10

GBSLM Series

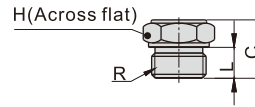

Model/Item	R	L	C	H	Weight(g)	PCS/bag
GBSLMM5	M5×0.8	3.5	9.5	8	2.3	10
GBSLM01	G1/8	5.5	11	11	4.4	10
GBSLM02	G1/4	6.5	13	15	8.1	10
GBSLM03	G3/8	7	14.5	19	14.9	10
GBSLM04	G1/2	8.5	17.5	22	24.5	10

GBESL Series

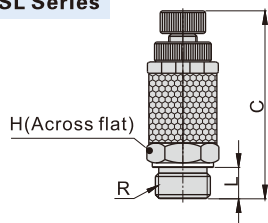

Model/Item	R	L	C		H	Weight(g)	PCS/bag
			max	min			
GBESL01	G1/8	5.5	40.5	33	12	10.1	10
GBESL02	G1/4	6.5	42	34.5	14	17.9	10
GBESL03	G3/8	7	48	40.5	17	30.3	10
GBESL04	G1/2	8.5	58.5	51	24	68.6	10